

PEAD-M R32 Ceiling Concealed Ducted System

Power Inverter Heat Pump (Single Phase)

The **PEAD-M Power Inverter** range is a ceiling concealed ducted system that blends a host of outstanding features with an unobtrusive design (only 250mm height) for easy installation and maintenance. Offering high seasonal efficiency, advanced control options and extended pipe runs, the units also come with a wide range of external static pressure settings, making this range an extremely flexible solution for applications such as light commercial, schools and warehousing.

Key Features & Benefits

- Increased comfort levels through advanced airflow and smart defrost features
- 100m pipe run (size 100-140), increasing application capability
- PAR-41MAA controller allows effective energy monitoring
- Improved efficiency through new fan motor
- Full heating capacity down to -3°C
- Drain pump included as standard
- Compatible with Plasma Quad Connect - an innovative, bolt-on air purifying device which neutralises viruses, bacteria, allergens, PM2.5, mould and dust. For more information, please refer to page 1.1.7



PEAD-M - INDOOR UNITS		PEAD-M35JA2	PEAD-M50JA2	PEAD-M60JA2	PEAD-M71JA2	PEAD-M100JA2	PEAD-M125JA2	PEAD-M140JA2
CAPACITY (kW)	Heating (nominal)	4.1 (1.6-5.2)	6.0 (2.5-7.3)	7.0 (2.8-8.2)	8.0 (3.5-10.2)	11.2 (4.5-14.0)	14.0 (5.0-16.0)	16.0 (5.7-18.0)
	Cooling (nominal)	3.6 (1.6-4.5)	5.0 (2.3-5.6)	6.1 (2.7-6.7)	7.1 (3.3-8.1)	9.5 (4.9-11.4)	12.5 (5.5-14.0)	13.4 (6.2-15.3)
	Heating (UK)	3.5 (1.35-4.4)	5.1 (2.15-6.2)	5.95 (2.4-6.95)	6.8 (3.0-8.65)	9.5 (3.85-11.9)	11.9 (4.25-13.6)	13.6 (4.85-15.3)
	Cooling (UK)	3.3 (1.45-4.15)	4.6 (2.1-5.15)	5.5 (2.5-6.15)	6.55 (3.05-7.45)	9.2 (4.5-10.5)	11.5 (5.05-12.9)	12.9 (5.7-14.1)
SHF (nominal)		0.85	0.84	0.83	0.80	0.82	0.78	0.77
COP / EER (nominal)		4.50 / 4.30	4.40 / 4.20	4.40 / 4.10	4.20 / 4.00	4.40 / 4.20	3.72 / 3.75	3.90 / 3.62
SCOP (ηsh) / SEER (ηsc) (BS EN14825)		4.1 (161.6%) / 6.3 (278.9%)	4.4 (174.1%) / 6.4 (274.1%)	4.2 (165.8%) / 6.2 (264.9%)	4.3 (170.1%) / 6.3 (265.6%)	4.4 (173.9%) / 6.6 (277.4%)	4.1 (163.2%) / 6.2 (256.3%)	4.1 (162.5%) / 6.2 (255.5%)
ERP ENERGY EFFICIENCY CLASS	Heating/Cooling	A / A++	A+ / A++	A+ / A++	A+ / A++	A+ / A++	A+ / A++	A+ / A++
AIRFLOW (l/s)	Lo-Mi-Hi	167-200-233	200-242-283	242-300-350	242-300-383	383-467-533	467-567-617	492-592-667
PIPE SIZE MM (in)	Gas	12.7 (1/2")	12.7 (1/2")	15.88 (5/8")	15.88 (5/8")	15.88 (5/8")	15.88 (5/8")	15.88 (5/8")
	Liquid	6.35 (1/4")	6.35 (1/4")	9.52 (3/8")	9.52 (3/8")	9.52 (3/8")	9.52 (3/8")	9.52 (3/8")
EXTERNAL STATIC PRESSURE (Pa)		35-50-70-100-150	35-50-70-100-150	35-50-70-100-150	35-50-70-100-150	35-50-70-100-150	35-50-70-100-150	35-50-70-100-150
SOUND PRESSURE LEVEL (dBA)	Lo-Mi-Hi	24-29-32	27-33-35	26-32-35	26-32-37	31-36-39	35-39-41	34-38-41
SOUND POWER LEVEL (dBA)		54	58	56	58	62	66	66
DIMENSIONS (mm)	Width x Depth x Height	900 x 732 x 250	900 x 732 x 250	1100 x 732 x 250	1100 x 732 x 250	1400 x 732 x 250	1400 x 732 x 250	1600 x 732 x 250
WEIGHT (kg)		25	26.5	29.5	29.5	37	38	42
ELECTRICAL SUPPLY		Fed by Outdoor Unit	Fed by Outdoor Unit	Fed by Outdoor Unit	Fed by Outdoor Unit	Fed by Outdoor Unit	Fed by Outdoor Unit	Fed by Outdoor Unit
FUSE RATING (BS88) - HRC (A)		6	6	6	6	6	6	6
INTERCONNECTING CABLE NO. CORES		4	4	4	4	4	4	4
WIRED REMOTE CONTROLLER REFERENCE		PAR-41MAA	PAR-41MAA	PAR-41MAA	PAR-41MAA	PAR-41MAA	PAR-41MAA	PAR-41MAA

PUZ-ZM - OUTDOOR UNITS		PUZ-ZM35VKA2	PUZ-ZM50VKA2	PUZ-ZM60VHA2	PUZ-ZM71VHA2	PUZ-ZM100VKA2	PUZ-ZM125VKA2	PUZ-ZM140VKA2
SOUND PRESSURE LEVEL (dBA)	Heating/Cooling	46 / 44	46 / 44	49 / 47	49 / 47	51 / 49	52 / 50	52 / 50
SOUND POWER LEVEL (dBA)	Cooling	65	65	67	67	69	70	70
WEIGHT (kg)		46	46	67	67	105	105	105
DIMENSIONS (mm)	Width x Depth x Height	809 x 300 x 630	809 x 300 x 630	950 x 330 + 25 x 943	950 x 330 + 25 x 943	1050 x 330 + 40 x 1338	1050 x 330 + 40 x 1338	1050 x 330 + 40 x 1338
ELECTRICAL SUPPLY		220-240v, 50Hz	220-240v, 50Hz	220-240v, 50Hz	220-240v, 50Hz	220-240v, 50Hz	220-240v, 50Hz	220-240v, 50Hz
PHASE		Single	Single	Single	Single	Single	Single	Single
SYSTEM POWER INPUT (kW)	Heating/Cooling (nominal)	0.911 / 0.837	1.363 / 1.190	1.590 / 1.487	1.904 / 1.775	2.545 / 2.261	3.763 / 3.333	4.102 / 3.701
	Heating/Cooling (UK)	0.76 / 0.76	1.15 / 1.05	1.30 / 1.37	1.70 / 1.50	2.03 / 1.94	3.34 / 2.83	3.65 / 3.15
STARTING CURRENT (A)		4.3	4.3	5.3	5.3	10.7	13.2	13.2
SYSTEM RUNNING CURRENT (A)	Heating/Cooling [MAX]	3.28 / 3.30 [14.2]	5.01 / 4.57 [14.4]	5.65 / 5.96 [20.9]	7.37 / 6.54 [20.9]	8.84 / 8.44 [22.3]	14.52 / 12.28 [28.8]	15.85 / 13.68 [32.6]
FUSE RATING (BS88) - HRC (A)		16	25	25	25	32	32	40
MAINS CABLE NO. CORES		3	3	3	3	3	3	3
MAX PIPE LENGTH (m)		50	50	55	55	100	100	100
MAX HEIGHT DIFFERENCE (m)		30	30	30	30	30	30	30
CHARGE REFRIGERANT (kg) / CO ₂ EQUIVALENT (t)	R32 (GWP 675)	2.00 / 1.35 (30m)	2.00 / 1.35 (30m)	2.80 / 1.89 (30m)	2.80 / 1.89 (30m)	3.60 / 2.43 (40m)	3.60 / 2.43 (40m)	3.60 / 2.43 (40m)
MAX ADDITIONAL REFRIGERANT (kg) / CO ₂ EQUIVALENT (t)	R32 (GWP 675)	0.30 / 0.20	0.30 / 0.20	0.80 / 0.54	0.80 / 0.54	2.40 / 1.62	2.40 / 1.62	2.40 / 1.62



Accessories

Indoor Units

MAC-100FT-E

Plasma Quad Connect air purifying device

PAC-HA31PAR

Plasma Quad Connect metal fitment

Outdoor Units

PAC-SJ07SG

Air outlet guide for PUZ-ZM35-50VKA2

PAC-SG59SG

Air outlet guide for PUZ-ZM60-71VHA2

PAC-SH96SG

Air outlet guide for PUZ-ZM100-140VKA2

PAC-SJ71FM-E

30Pa outdoor fan motor for PUZ-ZM100-140VKA2

System Control Units

PAC-SA89TA

Remote on/off adaptor (3 wire adaptor)

PAC-SA88HA

Run/fault adaptor (5 wire adaptor)

PAC-SE41TS-E

Remote sensor

PAR-CT01MAA-SB/PB

Touch screen wired remote controller (PB=Premium Finish)

PAR-41MAA

Standard wired remote controller

MAC-587IF-E

Interface for connection to Wi-Fi MELCloud service

MELCOBEMS MINI (A1M+)

Modbus and BACnet MSTP CN105 adaptor

MELCORETAIL MINI

Retail control and input / output interface

PAC-SK15MA-E

M-NET adaptor for size 35 and 50

PAC-SJ95MA

M-NET adaptor for size 60 to 140

Product Dimensions

PEAD-M35/50/60/71/100/125/140JA2

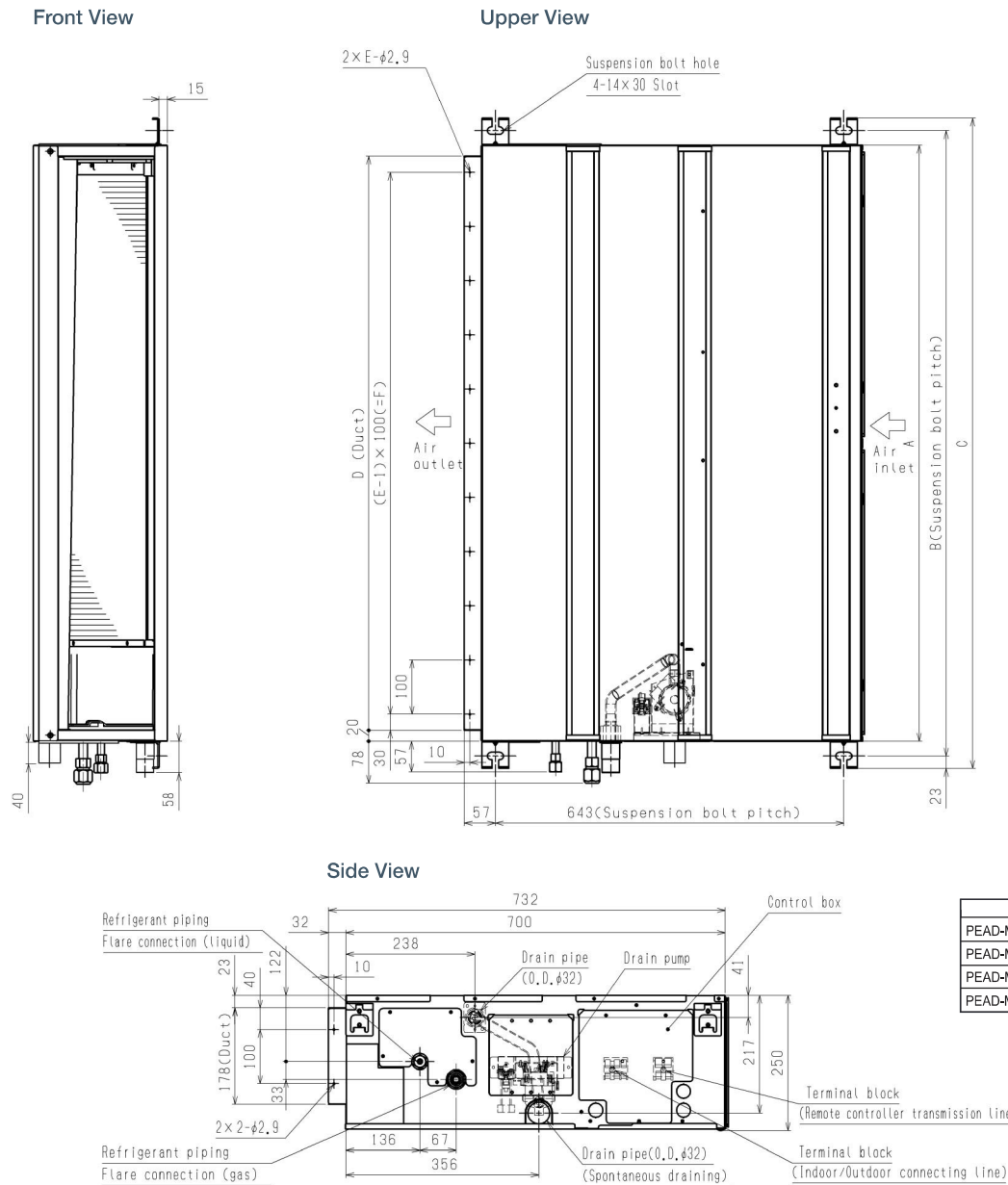

Model	A	B	C	D	E	F
PEAD-M35,50JA2	900	954	1000	860	9	800
PEAD-M60,71JA2	1100	1154	1200	1060	11	1000
PEAD-M100,125JA2	1400	1454	1500	1360	14	1300
PEAD-M140JA2	1600	1654	1700	1560	16	1500

Note: Please see page 1.3.66 for the full range of accessories.

PEAD-M R32 Ceiling Concealed Ducted System

Power Inverter Heat Pump (Three Phase)



The **PEAD-M Power Inverter** range is a ceiling concealed ducted system that blends a host of outstanding features with an unobtrusive design (only 250mm height) for easy installation and maintenance. Offering high seasonal efficiency, advanced control options and extended pipe runs, the units also come with a wide range of external static pressure settings, making this range an extremely flexible solution for applications such as light commercial, schools and warehousing.

Key Features & Benefits

- Increased comfort levels through advanced airflow and smart defrost features
- 100m pipe run, increasing application capability
- PAR-41MAA controller allows effective energy monitoring
- Improved efficiency through new fan motor
- Full heating capacity down to -3°C
- Drain pump included as standard
- Compatible with Plasma Quad Connect - an innovative, bolt-on air purifying device which neutralises viruses, bacteria, allergens, PM2.5, mould and dust. For more information, please refer to page 1.1.7

R32

PEAD-M - INDOOR UNITS		PEAD-M100JA2	PEAD-M125JA2	PEAD-M140JA2
CAPACITY (kW)	Heating (nominal)	11.2 (4.5-14.0)	14.0 (5.0-16.0)	16.0 (5.7-18.0)
	Cooling (nominal)	9.5 (4.9-11.4)	12.5 (5.5-14.0)	13.4 (6.2-15.3)
	Heating (UK)	9.5 (3.85-11.9)	11.9 (4.25-13.6)	13.6 (4.85-15.3)
	Cooling (UK)	9.2 (4.5-10.5)	11.5 (5.05-12.9)	12.9 (5.7-14.1)
SHF (nominal)		0.82	0.78	0.77
COP / EER (nominal)		4.40 / 4.20	3.72 / 3.75	3.90 / 3.62
SCOP (ηsh) / SEER (ηsc) (BS EN14825)		4.4 (173.8%) / 6.5 (275%)	4.1 (163.1%) / 6.1 (254.8%)	4.1 (162.5%) / 6.1 (254%)
ERP ENERGY EFFICIENCY CLASS	Heating/Cooling	A+ / A++	A+ / A++	A+ / A++
AIRFLOW (l/s)	Lo-Mi-Hi	383-467-533	467-567-617	492-592-667
PIPE SIZE MM (in)	Gas	15.88 (5/8")	15.88 (5/8")	15.88 (5/8")
	Liquid	9.52 (3/8")	9.52 (3/8")	9.52 (3/8")
EXTERNAL STATIC PRESSURE (Pa)		35-50-70-100-150	35-50-70-100-150	35-50-70-100-150
SOUND PRESSURE LEVEL (dBA)	Lo-Mi-Hi	31-36-39	35-39-41	34-38-41
SOUND POWER LEVEL (dBA)		62	66	66
DIMENSIONS (mm)	Width x Depth x Height	1400 x 732 x 250	1400 x 732 x 250	1600 x 732 x 250
WEIGHT (kg)		37	38	42
ELECTRICAL SUPPLY		Fed by Outdoor Unit	Fed by Outdoor Unit	Fed by Outdoor Unit
FUSE RATING (BS88) - HRC (A)		6	6	6
INTERCONNECTING CABLE NO. CORES		4	4	4
WIRED REMOTE CONTROLLER REFERENCE		PAR-41MAA	PAR-41MAA	PAR-41MAA
PUZ-ZM - OUTDOOR UNITS		PUZ-ZM100YKA2 ^③	PUZ-ZM125YKA2 ^③	PUZ-ZM140YKA2 ^③
SOUND PRESSURE LEVEL (dBA)	Heating/Cooling	51 / 49	52 / 50	52 / 50
	Cooling	69	70	70
SOUND POWER LEVEL (dBA)		69	70	70
WEIGHT (kg)		111	114	118
DIMENSIONS (mm)	Width x Depth x Height	1050 x 330 + 40 x 1338	1050 x 330 + 40 x 1338	1050 x 330 + 40 x 1338
ELECTRICAL SUPPLY		380-415v,50Hz	380-415v,50Hz	380-415v,50Hz
PHASE		Three	Three	Three
SYSTEM POWER INPUT (kW)	Heating/Cooling (nominal)	2.545 / 2.261	3.763 / 3.333	4.102 / 3.701
	Heating/Cooling (UK)	2.03 / 1.94	3.34 / 2.83	3.65 / 3.15
STARTING CURRENT (A)		2.6	3.3	3.3
SYSTEM RUNNING CURRENT (A)	Heating/Cooling [MAX]	5.08 / 4.85 [10.3]	8.35 / 7.06 [11.3]	9.12 / 7.86 [14.4]
FUSE RATING (BS88) - HRC (A)		16	16	16
MAINS CABLE NO. CORES		5	5	5
MAX PIPE LENGTH (m)		100	100	100
MAX HEIGHT DIFFERENCE (m)		30	30	30
CHARGE REFRIGERANT (kg) / CO ₂ EQUIVALENT (t)	R32 (GWP 675) - 40m	3.60 / 2.43	3.60 / 2.43	3.60 / 2.43
MAX ADDITIONAL REFRIGERANT (kg) / CO ₂ EQUIVALENT (t)	R32 (GWP 675)	2.40 / 1.62	2.40 / 1.62	2.40 / 1.62

^③ Three Phase



Accessories

Indoor Units

MAC-100FT-E

Plasma Quad Connect air purifying device

PAC-HA31PAR

Plasma Quad Connect metal fitment

Outdoor Units

PAC-SH96SG

Air outlet guide for PUZ-ZM100-140YKA2

PAC-SJ71FM-E

30Pa outdoor fan motor for PUZ-ZM100-140YKA2

System Control Units

PAC-SA89TA

Remote on/off adaptor (3 wire adaptor)

PAC-SA88HA

Run/fault adaptor (5 wire adaptor)

PAC-SE41TS-E

Remote sensor

PAR-CT01MAA-SB/PB

Touch screen wired remote controller (PB=Premium Finish)

PAR-41MAA

Standard wired remote controller

MAC-587IF-E

Interface for connection to Wi-Fi MELCloud service

MELCOBEMS MINI (A1M+)

Modbus and BACnet MSTP CN105 adaptor

MELCORETAIL MINI

Retail control and input / output interface

PAC-SJ95MA

M-NET adaptor for size 100 to 140

Product Dimensions

PEAD-M100/125/140JA2

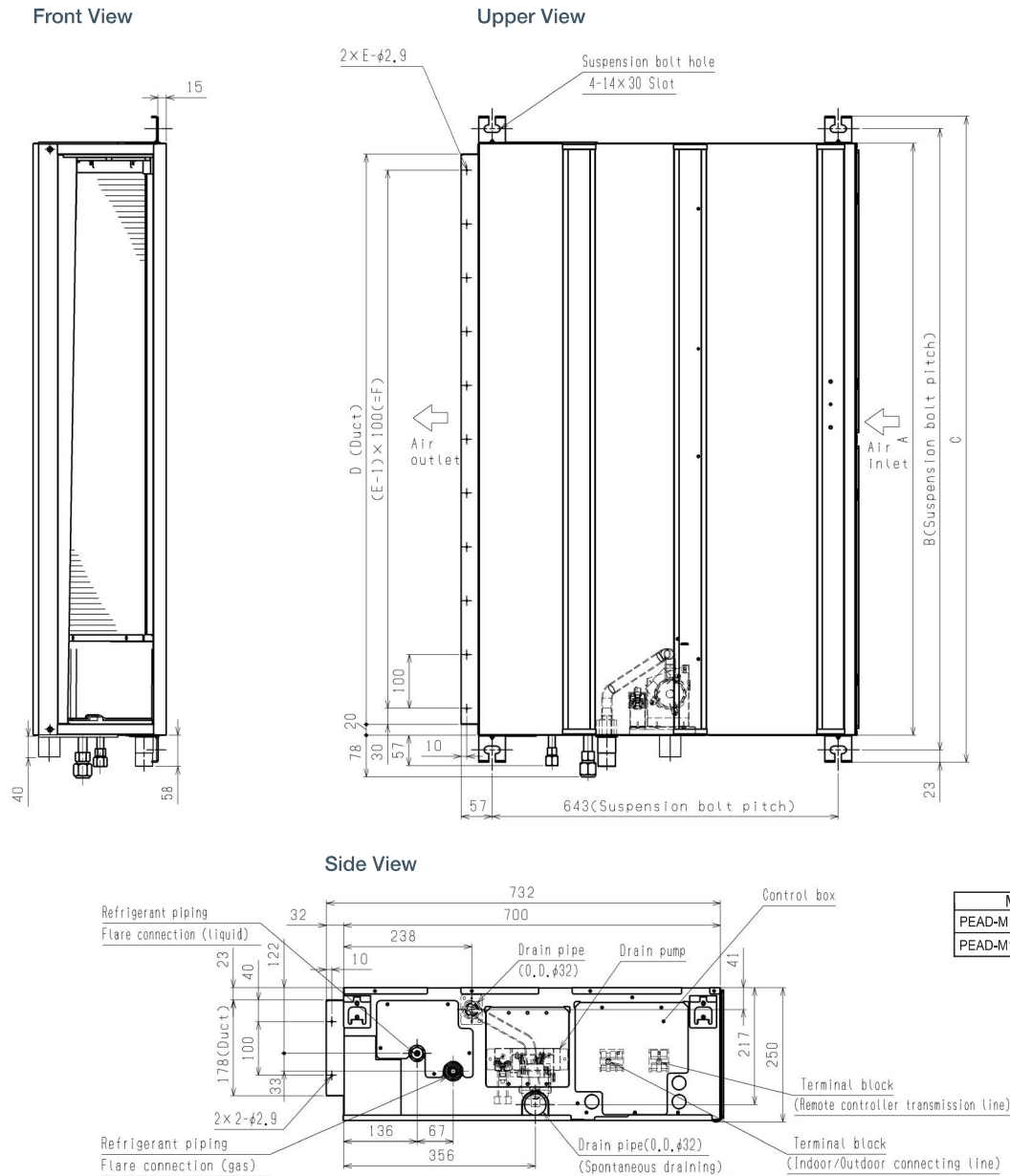

Model	A	B	C	D	E	F
PEAD-M100,125JA2	1400	1454	1500	1360	14	1300
PEAD-M140JA2	1600	1654	1700	1560	16	1500

Note: Please see page 1.3.66 for the full range of accessories.

PEAD-M R32 Ceiling Concealed Ducted System

Standard Inverter Heat Pump (Single Phase)

The cost effective **PEAD-M Standard Inverter** range is a ceiling concealed ducted system that blends a host of outstanding features with an unobtrusive design (only 250mm height) for easy installation and maintenance. Offering advanced control options and extended pipe runs, the units also come with a wide range of external static pressure settings, making this range an extremely flexible solution for applications such as light commercial, schools and warehousing.

Key Features & Benefits

- Increased comfort levels through advanced airflow and smart defrost features (size 100-140)
- PAR-41MAA controller allows effective energy monitoring
- Improved efficiency through new fan motor
- Drain pump included as standard
- Compatible with Plasma Quad Connect - an innovative, bolt-on air purifying device which neutralises viruses, bacteria, allergens, PM2.5, mould and dust. For more information, please refer to page 1.1.7

R32



PEAD-M - INDOOR UNITS		PEAD-M35JA2	PEAD-M50JA2	PEAD-M60JA2	PEAD-M71JA2	PEAD-M100JA2	PEAD-M125JA2	PEAD-M140JA2
CAPACITY (kW)	Heating (nominal)	4.1 (1.1-5.0)	6.0 (1.5-7.2)	7.0 (1.6-8.0)	8.0 (2.0-10.2)	11.2 (2.8-12.5)	13.5 (4.1-15.0)	15.0 (4.2-15.8)
	Cooling (nominal)	3.6 (0.8-3.9)	5.0 (1.7-5.6)	6.1 (1.6-6.3)	7.1 (2.2-8.1)	9.5 (4.0-10.6)	12.1 (6.0-13.0)	13.4 (6.1-14.1)
	Heating (UK)	3.49 (0.94-4.25)	5.10 (1.28-6.12)	5.96 (1.36-6.8)	6.80 (1.70-8.67)	9.63 (2.41-10.75)	11.61 (3.53-12.90)	12.90 (3.61-13.59)
	Cooling (UK)	3.31 (0.74-3.59)	4.60 (1.56-5.15)	5.16 (1.47-5.80)	6.53 (2.02-7.45)	8.65 (3.64-9.65)	11.01 (5.46-11.83)	12.19 (5.55-12.83)
SHF (nominal)		0.85	0.84	0.83	0.80	0.82	0.78	0.77
COP / EER (nominal)		4.00 / 3.90	4.10 / 3.70	3.80 / 3.60	3.80 / 3.50	3.80 / 3.30	3.61 / 3.01	3.61 / 2.81
SCOP (ηsh) / SEER (ηsc) (BS EN14825)		4.10(161.8%) / 6.30(260.9%)	4.20(166.9%) / 6.30(256.9%)	4.10(162.4%) / 6.10(250.5%)	4.10(161.6%) / 6.20(252.7%)	4.10(161.4%) / 6.10(257.3%)	3.80(152.1%) / 5.30(218.5%)	3.80(151.9%) / 5.20(213.3%)
EFP ENERGY EFFICIENCY CLASS	Heating/Cooling	A+ / A++	A+ / A++	A+ / A++	A+ / A++	A+ / A++	A / A	A / A
AIRFLOW (l/s)	Lo-Mi-Hi	167-200-233	200-242-283	242-300-350	242-300-383	383-467-533	467-567-617	492-592-667
PIPE SIZE mm (in)	Gas	9.52 (3/8")	12.7 (1/2")	15.88 (5/8")	15.88 (5/8")	15.88 (5/8")	15.88 (5/8")	15.88 (5/8")
	Liquid	6.35 (1/4")	6.35 (1/4")	6.35 (1/4")	9.52 (3/8")	9.52 (3/8")	9.52 (3/8")	9.52 (3/8")
EXTERNAL STATIC PRESSURE (Pa)		35-50-70-100-150	35-50-70-100-150	35-50-70-100-150	35-50-70-100-150	35-50-70-100-150	35-50-70-100-150	35-50-70-100-150
SOUND PRESSURE LEVEL (dBA)	Lo-Mi-Hi	24-29-32	27-33-35	26-32-35	26-32-37	31-36-39	35-39-41	34-38-41
SOUND POWER LEVEL (dBA)		54	58	56	58	62	66	66
DIMENSIONS (mm)	Width x Depth x Height	900 x 732 x 250	900 x 732 x 250	1100 x 732 x 250	1100 x 732 x 250	1400 x 732 x 250	1400 x 732 x 250	1600 x 732 x 250
WEIGHT (kg)		25	26.5	29.5	29.5	37	38	42
ELECTRICAL SUPPLY		Fed by Outdoor Unit	Fed by Outdoor Unit	Fed by Outdoor Unit	Fed by Outdoor Unit	Fed by Outdoor Unit	Fed by Outdoor Unit	Fed by Outdoor Unit
FUSE RATING (BS88) - HRC (A)		6	6	6	6	6	6	6
INTERCONNECTING CABLE No. Cores		4	4	4	4	4	4	4
WIRED REMOTE CONTROLLER REFERENCE		PAR-41MAA	PAR-41MAA	PAR-41MAA	PAR-41MAA	PAR-41MAA	PAR-41MAA	PAR-41MAA

SUZ-M / PUZ-M - OUTDOOR UNITS		SUZ-M35VAR2	SUZ-M50VAR2	SUZ-M60VAR2	SUZ-M71VAR1	PUZ-M100VKA2	PUZ-M125VKA2	PUZ-M140VKA2
SOUND PRESSURE LEVEL (dBA)	Heating/Cooling	48 / 48	48 / 49	49 / 51	49 / 51	51 / 54	54 / 56	55 / 57
SOUND POWER LEVEL (dBA)	Cooling	59	64	65	66	70	72	73
WEIGHT (kg)		35	41	54	56	76	84	84
DIMENSIONS (mm)	Width x Depth x Height	800 x 285 x 550	800 x 285 x 714	840 x 330 x 880	840 x 330 x 880	1050 x 330 x 981	1050 x 330 x 981	1050 x 330 x 981
ELECTRICAL SUPPLY		220-240v, 50Hz	220-240v, 50Hz	220-240v, 50Hz	220-240v, 50Hz	220-240v, 50Hz	220-240v, 50Hz	220-240v, 50Hz
PHASE		Single	Single	Single	Single	Single	Single	Single
SYSTEM POWER INPUT (kW)	Heating/Cooling (nominal)	1.025 / 0.923	1.463 / 1.351	1.842 / 1.694	2.105 / 2.028	2.947 / 2.878	3.739 / 4.019	4.155 / 4.768
	Heating/Cooling (UK)	0.85 / 0.84	1.24 / 1.19	1.50 / 1.56	1.87 / 1.72	2.35 / 2.47	3.32 / 3.41	3.69 / 4.05
STARTING CURRENT (A)		5.0	5.7	7.6	10.0	7.1	2.9	2.9
SYSTEM RUNNING CURRENT (A)	Heating/Cooling [MAX]	3.69 / 3.64 [9.7]	5.38 / 5.18 [14.9]	6.54 / 6.78 [16.7]	8.15 / 7.47 [16.7]	10.23 / 10.75 [22.3]	14.43 / 14.81 [27.8]	16.06 / 17.62 [31.4]
FUSE RATING (BS88) - HRC (A)		16	20	20	20	32	32	40
MAINS CABLE No. Cores		3	3	3	3	3	3	3
MAX PIPE LENGTH (m)		20	30	30	30	55	65	65
MAX HEIGHT DIFFERENCE (m)		12	30	30	30	30	30	30
CHARGE REFRIGERANT (KG) / CO ₂ EQUIVALENT (T)	R32 (GWP 675)	0.90 / 0.61 (7m)	1.20 / 0.81 (7m)	1.25 / 0.84 (7m)	1.45 / 0.98 (7m)	3.10 / 2.09 (30m)	3.60 / 2.43 (30m)	3.60 / 2.43 (30m)
MAX ADDITIONAL REFRIGERANT (KG) / CO ₂ EQUIVALENT (T)	R32 (GWP 675)	1.16 / 0.78	1.66 / 1.12	1.71 / 1.15	2.37 / 1.80	4.10 / 2.77	5.00 / 3.38	5.00 / 3.38

Note: No duty/standby operation on SUZ-M35/50/60/71VAR2/1.

Accessories

Indoor Units

MAC-100FT-E

Plasma Quad Connect air purifying device

PAC-HA31PAR

Plasma Quad Connect metal fitment

Outdoor Units

MAC-881SG

Air outlet guide for SUZ-M35VAR2

MAC-882SG

Air outlet guide for SUZ-M50VAR2

MAC-886SG

Air outlet guide for SUZ-M60VAR2 / SUZ-M71VAR1

PAC-SH96SG

Air outlet guide for PUZ-M100-140VKA2

System Control Units

PAC-SA89TA

Remote on/off adaptor (3 wire adaptor)

PAC-SA88HA

Run/fault adaptor (5 wire adaptor)

PAC-SE41TS-E

Remote sensor

PAR-CT01MAA-SB/PB

Touch screen wired remote controller (PB=Premium Finish)

PAR-41MAA

Standard wired remote controller

MAC-334IF-E

Interface for M-NET, MA remote controller (PAR-41MAA / PAR-CT01MAA), on/off input and run/fault output

MAC-497IF-E

Interface for MA remote controller (PAR-41MAA / PAR-CT01MAA)

MAC-587IF-E

Interface for connection to Wi-Fi MELCcloud service

MELCOBEMS MINI (A1M+)

Modbus and BACnet MSTP CN105 adaptor

MELCORETAIL MINI

Retail control and input / output interface

PAC-SJ95MA

M-NET adaptor for size 100 to 140

Product Dimensions

PEAD-M35/50/60/71/100/125/140JA2

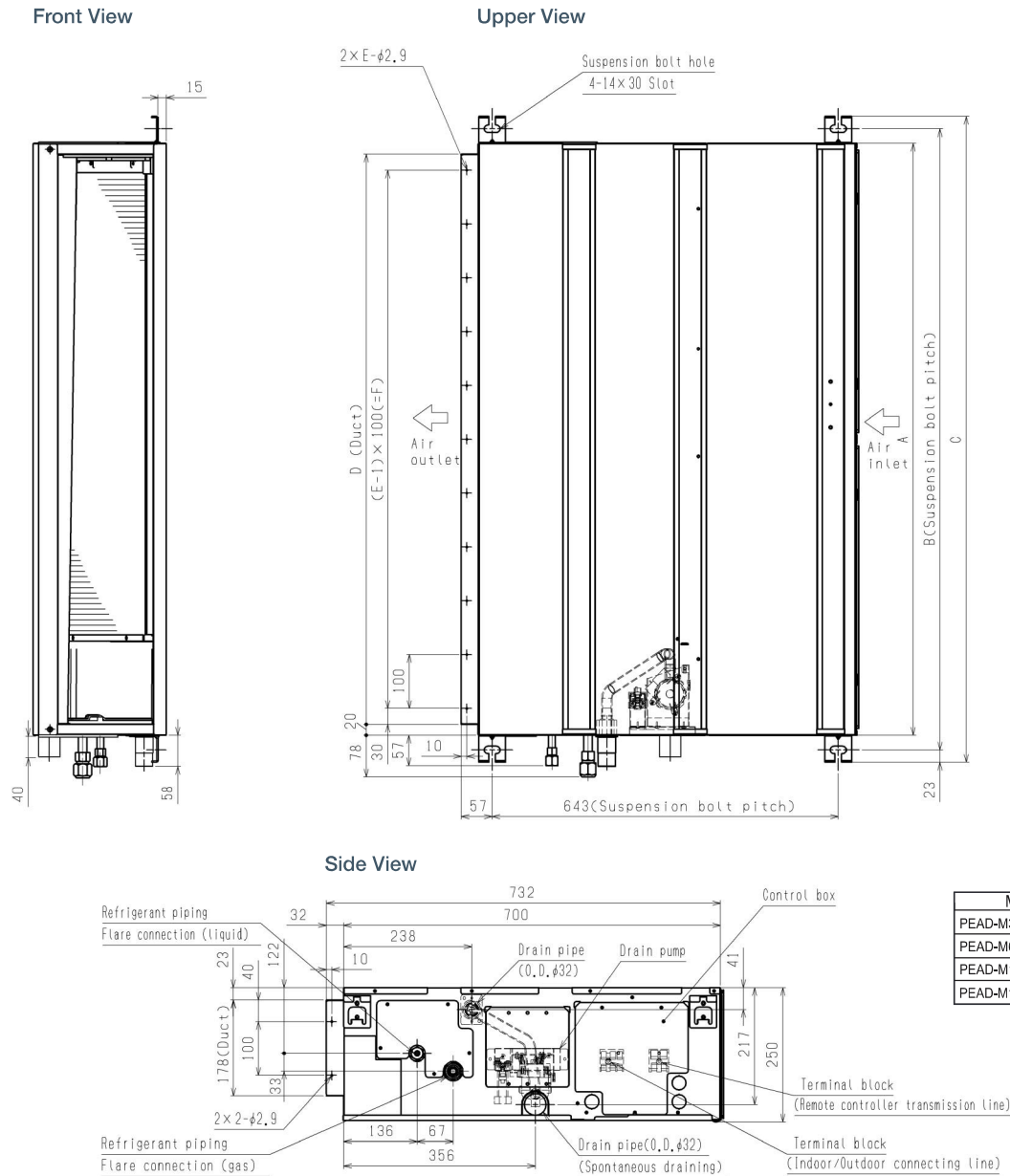

Model	A	B	C	D	E	F
PEAD-M35,50JA2	900	954	1000	860	9	800
PEAD-M60,71JA2	1100	1154	1200	1060	11	1000
PEAD-M100,125JA2	1400	1454	1500	1360	14	1300
PEAD-M140JA2	1600	1654	1700	1560	16	1500

Note: Please see page 1.3.66 for the full range of accessories.

PEAD-M R32 Ceiling Concealed Ducted System

Standard Inverter Heat Pump (Three Phase)



The cost effective **PEAD-M Standard Inverter** range is a ceiling concealed ducted system that blends a host of outstanding features with an unobtrusive design (only 250mm height) for easy installation and maintenance. Offering advanced control options and extended pipe runs, the units also come with a wide range of external static pressure settings, making this range an extremely flexible solution for applications such as light commercial, schools and warehousing.

Key Features & Benefits

- Increased comfort levels through advanced airflow and smart defrost features
- PAR-41MAA controller allows effective energy monitoring
- Improved efficiency through new fan motor
- Drain pump included as standard
- Compatible with Plasma Quad Connect - an innovative, bolt-on air purifying device which neutralises viruses, bacteria, allergens, PM2.5, mould and dust. For more information, please refer to page 1.1.7



PEAD-M - INDOOR UNITS		PEAD-M100JA2	PEAD-M125JA2	PEAD-M140JA2
CAPACITY (kW)	Heating (nominal)	11.2 (2.8-12.5)	13.5 (4.1-15.0)	15.0 (4.2-15.8)
	Cooling (nominal)	9.5 (4.0-10.6)	12.1 (6.0-13.0)	13.4 (6.1-14.1)
	Heating (UK)	9.63 (2.41-10.75)	11.61 (3.53-12.90)	12.90 (3.61-13.59)
	Cooling (UK)	8.65 (3.64-9.65)	11.01 (5.46-11.83)	12.19 (5.55-12.83)
SHF (nominal)		0.82	0.78	0.77
COP / EER (nominal)		3.80 / 3.30	3.61 / 3.01	3.61 / 2.81
SCOP (ηsh) / SEER (ηsc) (BS EN14825)		4.10 (161.4%) / 6.10 (257.3%)	3.80 (152.1%) / 5.30 (218.5%)	3.80 (151.9%) / 5.20 (213.3%)
ErP ENERGY EFFICIENCY CLASS	Heating/Cooling	A+ / A++	A / A	A / A
AIRFLOW (l/s)	Lo-Mi-Hi	383-467-533	467-567-617	492-592-667
PIPE SIZE mm (in)	Gas	15.88 (5/8")	15.88 (5/8")	15.88 (5/8")
	Liquid	9.52 (3/8")	9.52 (3/8")	9.52 (3/8")
EXTERNAL STATIC PRESSURE (Pa)		35-50-70-100-150	35-50-70-100-150	35-50-70-100-150
SOUND PRESSURE LEVEL (dBA)	Lo-Mi-Hi	31-36-39	35-39-41	34-38-41
SOUND POWER LEVEL (dBA)		62	66	66
DIMENSIONS (mm)	Width x Depth x Height	1400 x 732 x 250	1400 x 732 x 250	1600 x 732 x 250
WEIGHT (kg)		37	38	42
ELECTRICAL SUPPLY		Fed by Outdoor Unit	Fed by Outdoor Unit	Fed by Outdoor Unit
FUSE RATING (BS88) - HRC (A)		6	6	6
INTERCONNECTING CABLE No. Cores		4	4	4
WIRED REMOTE CONTROLLER REFERENCE		PAR-41MAA	PAR-41MAA	PAR-41MAA

PUZ-M - OUTDOOR UNITS		PUZ-M100YKA2 ^③	PUZ-M125YKA2 ^③	PUZ-M140YKA2 ^③
SOUND PRESSURE LEVEL (dBA)	Heating/Cooling	51 / 54	54 / 56	55 / 57
	Cooling	70	72	73
SOUND POWER LEVEL (dBA)		78	85	85
WEIGHT (kg)		78	85	85
DIMENSIONS (mm)	Width x Depth x Height	1050 x 330 x 981	1050 x 330 x 981	1050 x 330 x 981
ELECTRICAL SUPPLY		380-415v, 50Hz	380-415v, 50Hz	380-415v, 50Hz
PHASE		Three	Three	Three
SYSTEM POWER INPUT (kW)	Heating/Cooling (nominal)	2.947 / 2.878	3.739 / 4.019	4.155 / 4.768
	Heating/Cooling (UK)	2.35 / 2.47	3.32 / 3.41	3.69 / 4.05
STARTING CURRENT (A)		3.5	4.9	4.9
SYSTEM RUNNING CURRENT (A)	Heating/Cooling [MAX]	5.88 / 6.18 [13.8]	8.30 / 8.52 [12.8]	9.23 / 10.13 [12.9]
FUSE RATING (BS88) - HRC (A)		16	16	16
MAINS CABLE No. Cores		5	5	5
MAX PIPE LENGTH (m)		55	65	65
MAX HEIGHT DIFFERENCE (m)		30	30	30
CHARGE REFRIGERANT (KG) / CO ₂ EQUIVALENT (T)	R32 (GWP 675) - 30m	3.10 / 2.09	3.60 / 2.43	3.60 / 2.43
MAX ADDITIONAL REFRIGERANT (KG) / CO ₂ EQUIVALENT (T)	R32 (GWP 675)	4.10 / 2.77	5.00 / 3.38	5.00 / 3.38

^③ Three Phase

Accessories

Indoor Units

MAC-100FT-E

Plasma Quad Connect air purifying device

PAC-HA31PAR

Plasma Quad Connect metal fitment

Outdoor Units

PAC-SH96SG

Air outlet guide for PUZ-M100-140YKA2

System Control Units

PAC-SA89TA

Remote on/off adaptor (3 wire adaptor)

PAC-SA88HA

Run/fault adaptor (5 wire adaptor)

PAC-SE41TS-E

Remote sensor

PAR-CT01MAA-SB/PB

Touch screen wired remote controller (PB=Premium Finish)

PAR-41MAA

Standard wired remote controller

MAC-587IF-E

Interface for connection to Wi-Fi MELCloud service

MELCOBEMS MINI (A1M+)

Modbus and BACnet MSTP CN105 adaptor

MELCORETAIL MINI

Retail control and input / output interface

PAC-SJ95MA

M-NET adaptor for size 100 to 140

Product Dimensions

PEAD-M100/125/140JA2

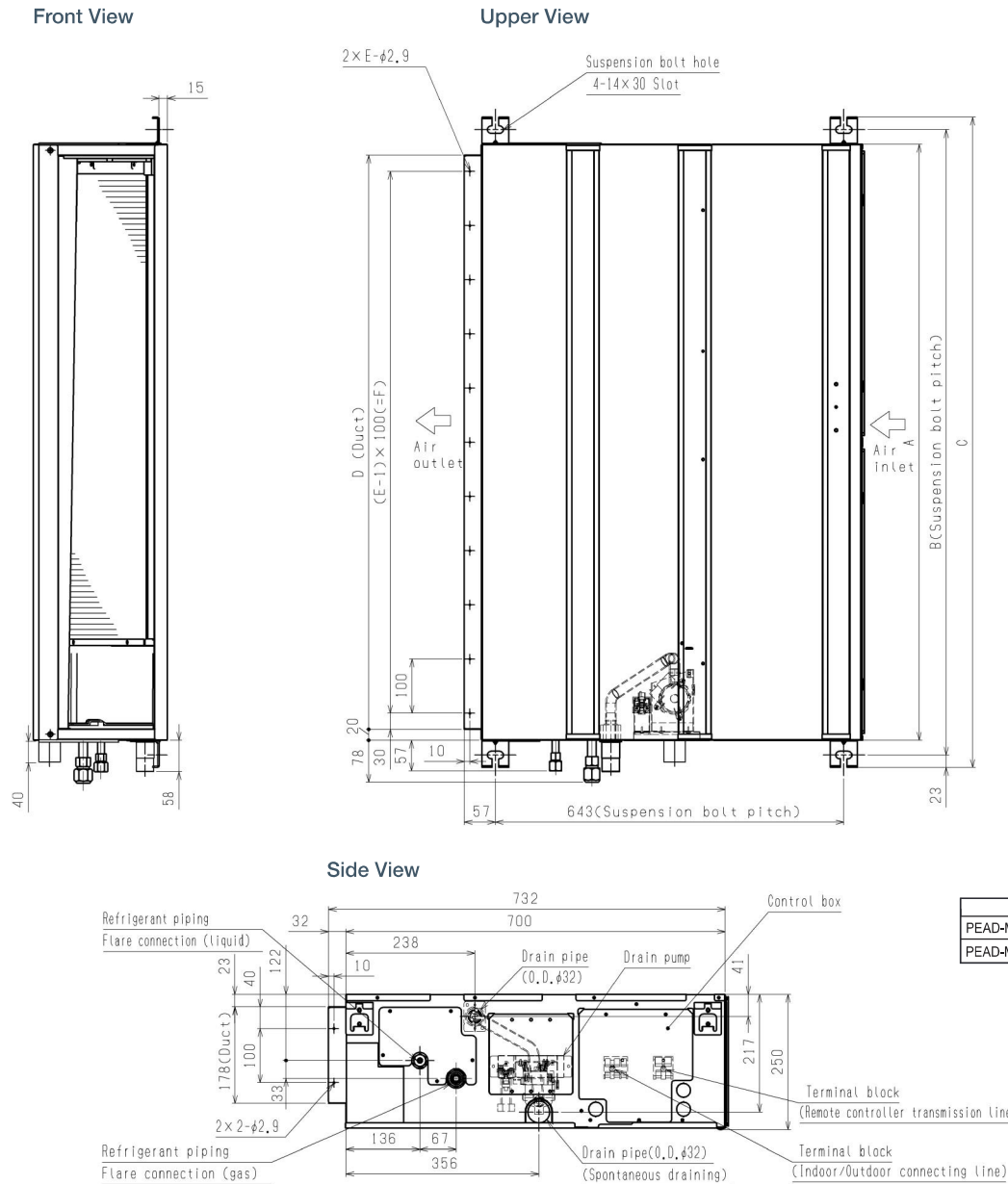

Note: Please see page 1.3.66 for the full range of accessories.